

CAMRY

POWERED
BY



2009 Quick Reference Guide

Have a question about the main features of your new Toyota? Find the answers quickly and easily in this Quick Reference Guide, which includes highlights from the *Owner's Manual*. For more detailed information, and helpful interactive demonstrations and tips, visit www.Toyotaiguide.com. This user-friendly website makes learning all about your new vehicle fun and easy.

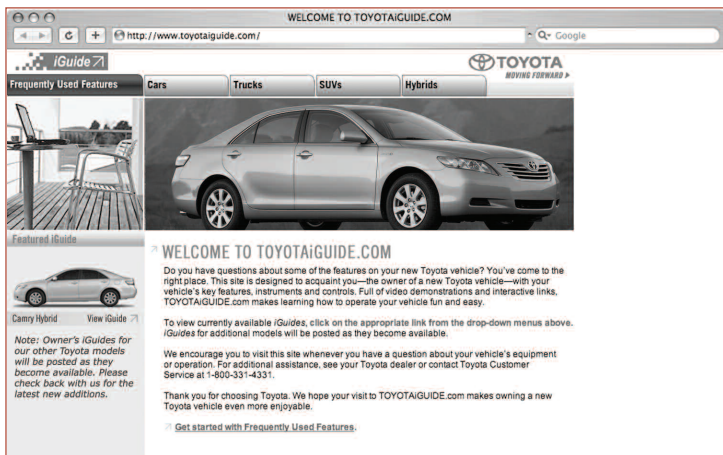

www.Toyotaiguide.com

This *iGuide* is not intended as a substitute for the *Owner's Manual* located in the vehicle's glove box. We strongly encourage you to review the *Owner's Manual* and supplementary manuals so you will have a better understanding of the vehicle's capabilities and limitations. Important **Cautions**, to help you avoid injuries, and **Notices**, to help you avoid equipment damage or malfunction, can also be found in the *Owner's Manual*.

2009 Camry Hybrid Quick Reference Guide

OVERVIEW

Engine maintenance	9
Fuel tank door release and cap	8
Hood release	9
Indicator symbols	5
Instrument cluster	4
Instrument panel	2-3
Keyless entry¹	6
Light control-Instrument panel	8
Smart Key system^{1,2}	7

FEATURES/OPERATIONS

Air Conditioning/Heating	20-21
Audio	18-19
Auto lock functions²	11
Clock	21
Cruise control	15
Cup holders	22
Door locks	22
Garage door opener (HomeLink [®]) ³	15
Hybrid Synergy Drive System	10
Lights¹ & turn signals	13
Moonroof	17
Multi-information display	17
Parking brake	12
Power outlets	22
Seat adjustments-Front	14
Seat heaters	21
Seats-Folding rear seats	14
Seats-Head restraints	14
Steering lock release	11
Steering wheel switches	19
Telephone controls (Bluetooth [®])	16
Tilt and telescopic steering wheel	12
Transmission	11
Windows-Power	12
Windshield wipers & washers	13

SAFETY AND

EMERGENCY FEATURES

Child comfort guide	24
Doors-Child safety locks	23
Fuel filler door-Internal release	23
Seat belts	23
Seat belts-Shoulder belt anchor	24
Spare tire & tools	25
Tire Pressure Warning System	24
Trunk-Internal release	25

¹ Visit your Toyota dealer for information on customizing this feature.

² Programmable by customer. Refer to the Owner's Manual for instructions and more information.

³ HomeLink[®] is a registered trademark of Johnson Controls, Inc.

OVERVIEW

Instrument panel

Steering wheel controls

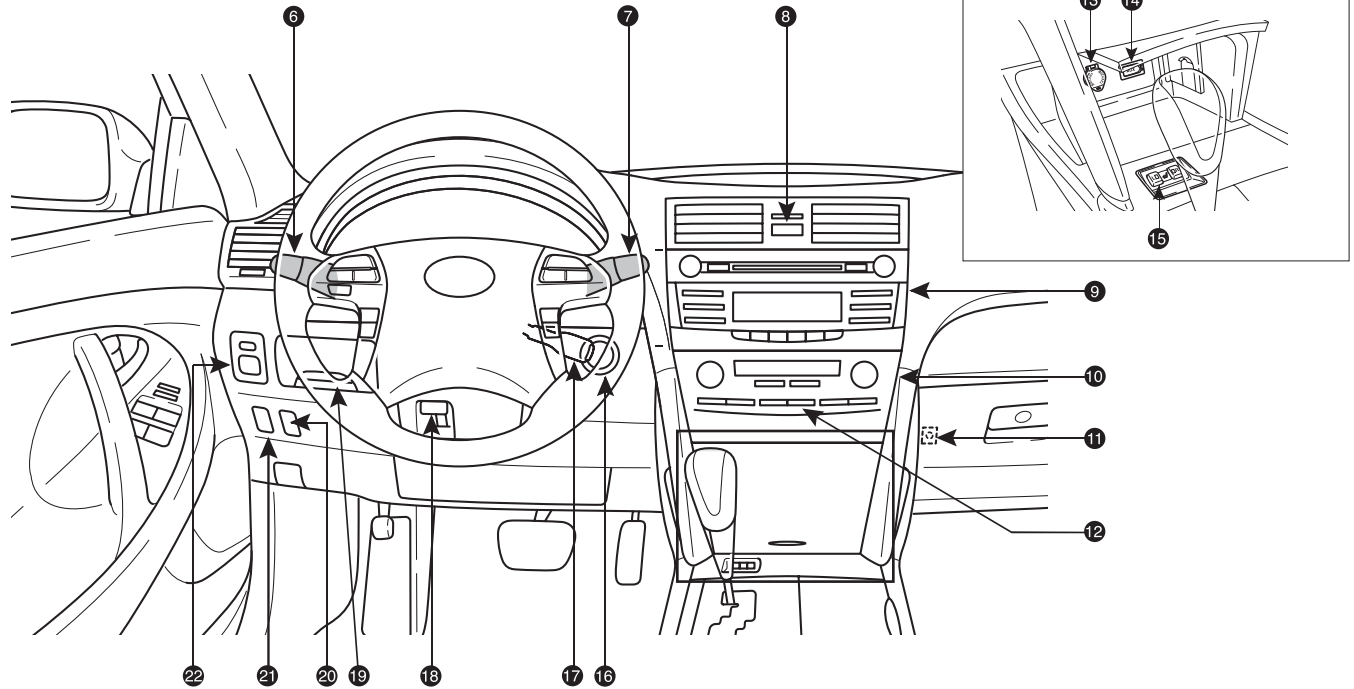
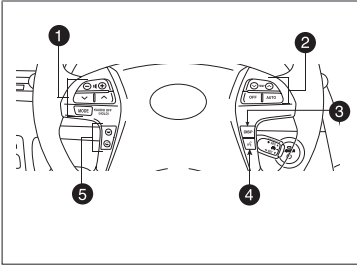

- ❶ Steering wheel audio controls
- ❷ Steering wheel climate controls
- ❸ Multi-information display button
- ❹ Voice command button^{1,2}
- ❺ Telephone controls^{1,2}
- ❻ Headlight and turn signal controls
- ❼ Wiper and washer controls
- ❽ Emergency flasher button
- ❾ Audio system or navigation system with integrated audio system^{1,2}
- ❿ Air Conditioning controls
- ⓫ Tire Pressure Warning System reset (in glove box)
- ⓬ Rear window and outside rearview mirror defogger switch¹
- ⓭ 12V DC Power outlet

- ⓮ AUX audio jack
- ⓯ Seat heater controls¹
- ⓰ "POWER" switch
- ⓱ Cruise control
- ⓲ Tilt and telescopic steering lock release
- ⓳ Auxiliary boxes
- ⓴ Air Conditioning/Heating economy (ECO) mode switch
- ⓵ Fuel filler door opener
- ⓶ Power outside rearview mirror controls

¹ If equipped





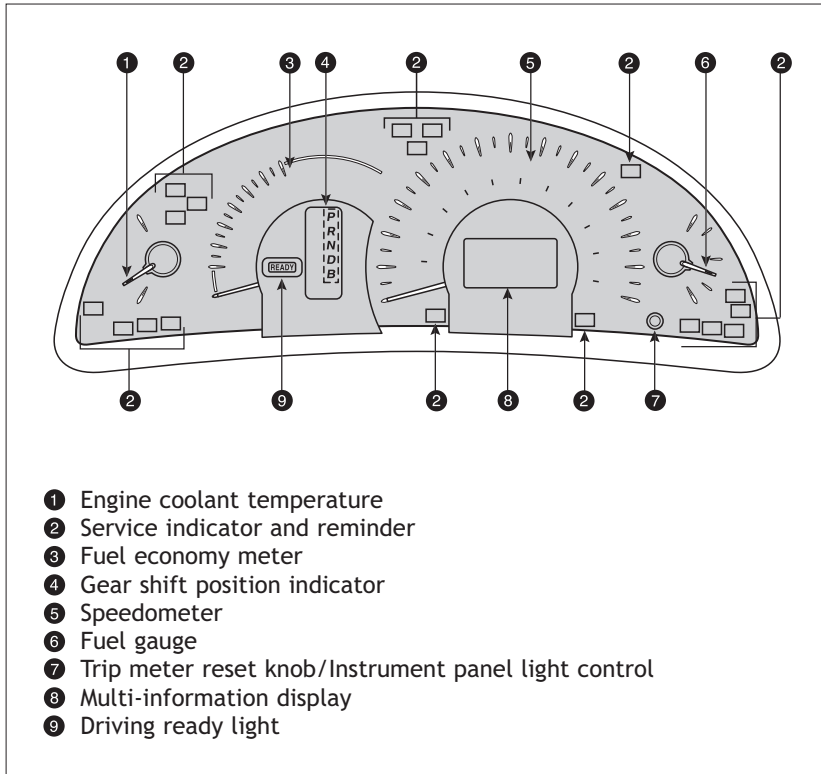











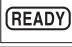



² For details, refer to the "Navigation System Owner's Manual."

Instrument cluster

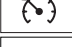

Indicator symbols

For details, refer to “Indicators and warning lights,” Section 2-2, 2009 Owner’s Manual.

-  **BRAKE** Brake system warning¹
-  Brake system warning light¹
-  Driver seat belt reminder (alarm will sound if speed is over 12 mph)
-  Front passenger seat belt reminder (alarm will sound if speed is over 12 mph)
-  Charging system warning¹
-  Front passenger occupant classification or front passenger air bag ON/OFF indicator¹
-  **READY** Driving ready light
-  Malfunction/Check Engine indicator¹
-  Low fuel level warning
-  Open door warning
-  Airbag SRS warning¹
-  Master warning
-  Low Tire Pressure Warning¹
-  **P/S** Electric power steering system warning¹
-  Theft deterrent/Engine immobilizer system indicator
-  Headlight low/high beam indicator
-  Turn signal indicator
-  Slip indicator¹
-  Cruise control indicator²
-  **ABS** Anti-lock Brake System warning¹

¹ If indicator does not turn off within a few seconds of starting engine, there may be a malfunction. Have vehicle inspected by your Toyota dealer.

² If this light flashes, refer to “Cruise control,” Section 2-4, 2009 Owner’s Manual.

Keyless entry

Locking operation



Unlocking operation

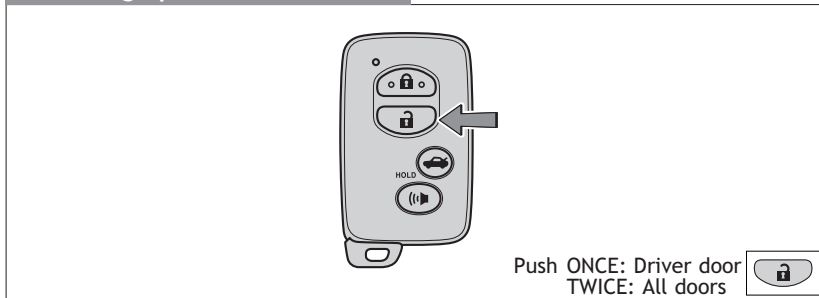

NOTE: If a door is not opened within 60 seconds of unlocking, all doors will relock for safety.

Trunk lid operation

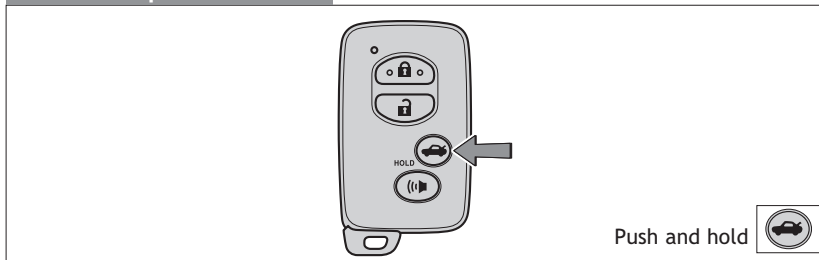

Panic button



Smart Key system*

Start function

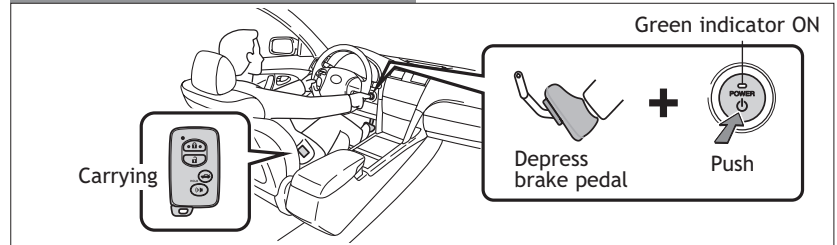

NOTE: Gear shift lever must be in “Park” and brake pedal depressed.

Power (without starting Hybrid System)

Without depressing the brake pedal, pressing the “POWER” switch will change the operation mode in succession from:

- ACC** Accessories such as the radio will operate.
- ON** Power ON; the Hybrid System not running.
- OFF** All systems OFF.

Locking/Unlocking operation

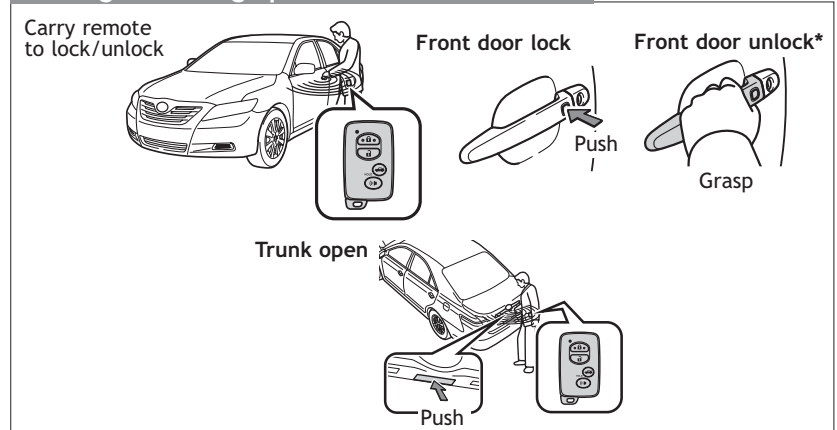

* Driver door unlocking function can be programmed to unlock driver door only, or all doors. Grasping front passenger door handle will unlock all doors.

NOTE: Doors may also be locked/unlocked using remote.

Fuel tank door release and cap

(1) Push*

(2) PLEASE WAIT NOW OPENING
ODO 237 miles

(3) REFUEL READY
ODO 237 miles

(4) Turn

(5) Store

* It may take up to 10 seconds after pushing button for the door to open if the internal tank pressure is high.

NOTE: Tighten until one click is heard. If the cap is not tightened enough, Check Engine “” indicator may illuminate.

Light control-Instrument panel

Brightness control

This is also the trip meter reset button.

Hood release

Pull

Pull up latch and raise hood

Engine maintenance

1 2 3 4

- 1 Engine oil filler cap
- 2 Engine oil level dipstick
- 3 Windshield washer fluid tank
- 4 Engine coolant reservoir

Note: Regularly scheduled maintenance, including oil changes, will help extend the life of your vehicle and maintain performance. Please refer to the “Owner’s Warranty Information Booklet,” “Scheduled Maintenance Guide” or “Owner’s Manual Supplement.”

FEATURES/OPERATIONS

Hybrid Synergy Drive System

The Hybrid Synergy Drive System utilizes a computer controlled gasoline engine and electric motor to provide the most efficient combination of power for the vehicle. To conserve energy, when the brakes are applied the braking force generates electricity which is then sent to the traction battery. In addition, the engine shuts off when the vehicle is stopped. The benefits are better fuel economy, reduced vehicle emissions and improved performance.

Note: Fuel consumption and energy information of the Hybrid System are shown on the multi-information display and/or navigation system screen (if equipped).

Tips for improved fuel economy

1. Ensure tire pressures are maintained at levels specified in the *Owner's Manual*.
2. Link trips, if possible, to reduce engine cold starts.
3. Avoid driving at speeds that are higher than necessary, especially on the highway.
4. When possible, avoid sudden stops to maximize regenerative braking energy.
5. Minimize use of the Air Conditioning.

Starting the Hybrid System

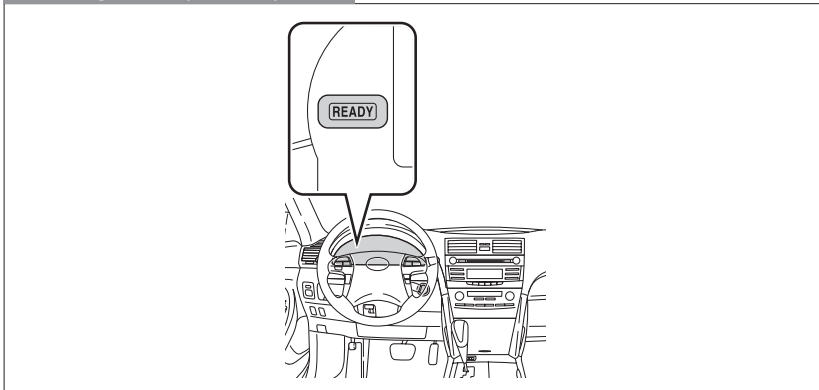

- (1) Put the selector lever in "P."
- (2) Depress the brake pedal, and press the "POWER" switch briefly and firmly.
- (3) The "READY" light will blink. After a few seconds, when the light remains steady and a beep sounds, you may begin driving.

Auto lock functions

Automatic door locks can be programmed to operate in four different modes, or turned OFF.

- Doors lock when shifting from "Park."
- Doors lock when the vehicle speed goes above approximately 12 mph.
- Doors unlock when shifting into "Park."
- Doors unlock when the "POWER" switch is set from ON to ACC or OFF and driver's door is opened.

Refer to the *Owner's Manual* for more details.

Transmission

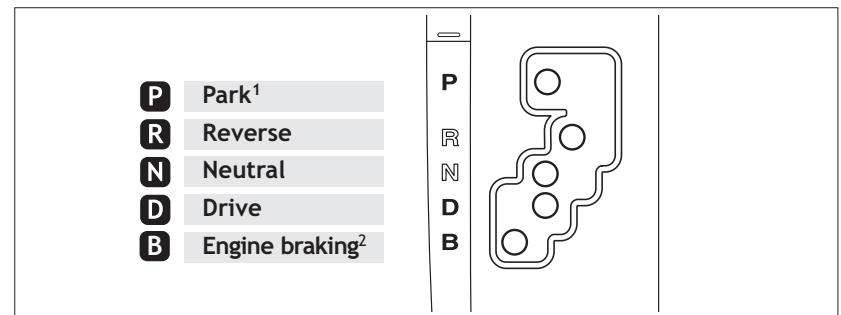

¹ The "POWER" switch must be set at ON, and the brake pedal depressed to shift from "Park."

² The engine brake is the equivalent of downshifting. Shift to "B" when engine braking is desired (i.e. downhill driving, coasting to a stop, etc.).

Steering lock release

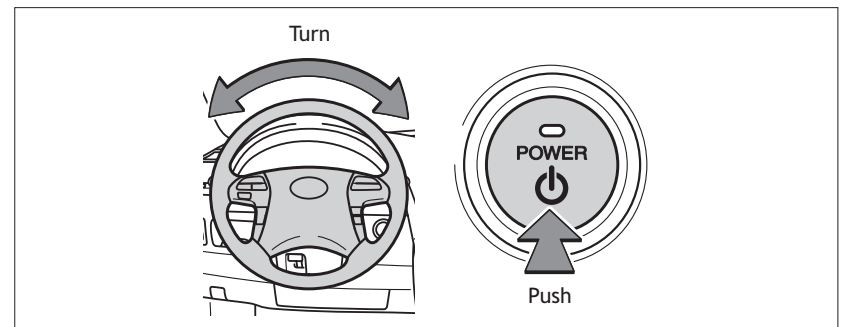

Gently turn wheel while pressing the POWER switch. If the lock does not release, the switch indicator will flash green.

Tilt and telescopic steering wheel

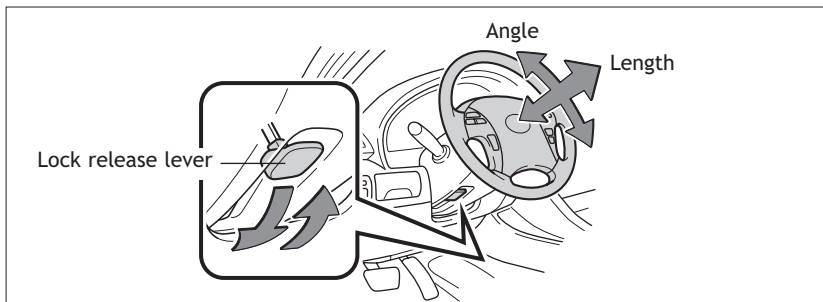

Hold wheel, push lever down, set angle and length, and return lever.

Note: Do not attempt to adjust while the vehicle is in motion.

Parking brake

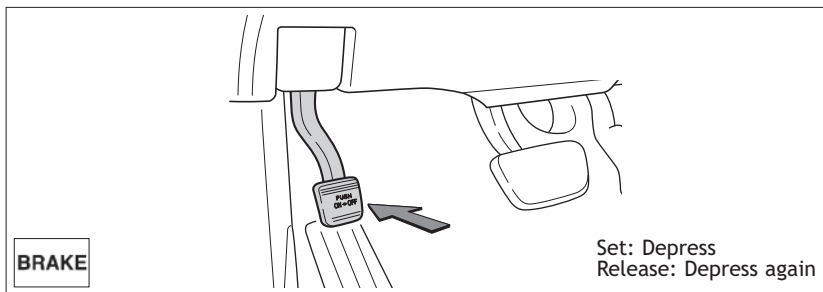

Windows-Power

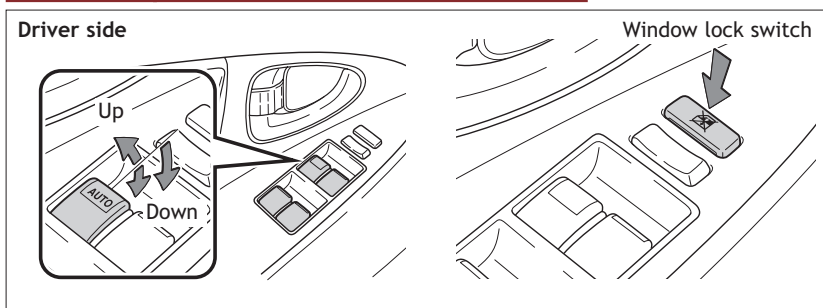

Automatic down operation (driver side only) Push the switch completely down and release to fully open. To stop window midway, lightly pull the switch up.

Window lock switch Deactivates all passenger windows. Driver's window remains operable.

Windshield wipers & washers

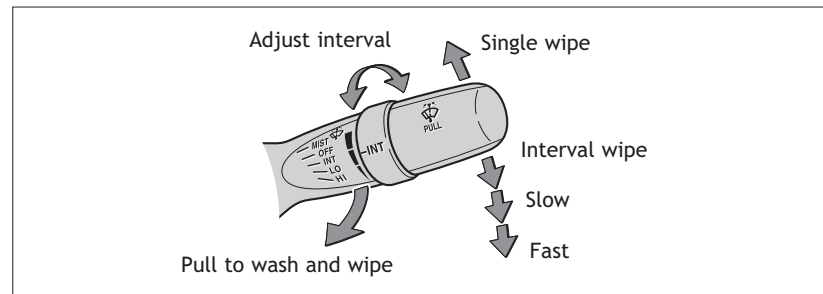

Lights & turn signals

Headlights

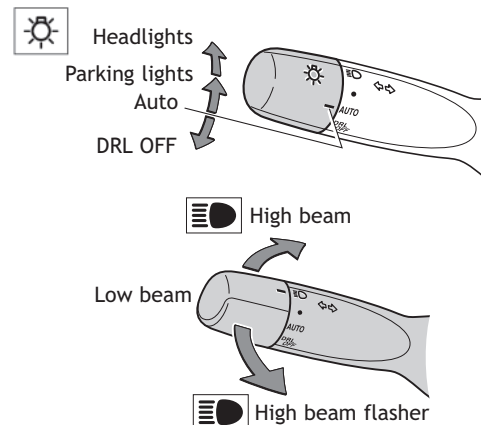

-Daytime Running Light system (DRL) Automatically turns on the turn signal lights at a reduced intensity.

-Automatic light cut off system Automatically turns lights off after a delay of 30 seconds, or the lock switch on remote may be pushed.

Turn signals

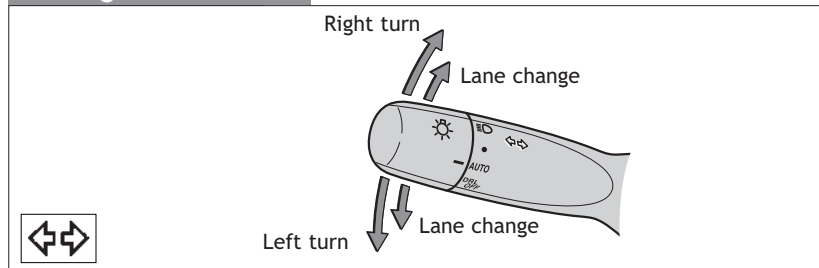

Seat adjustments-Front

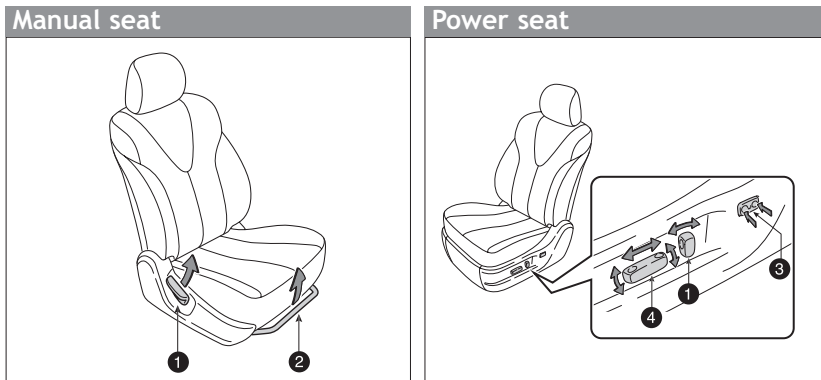

- ① Seatback angle
- ② Position
- ③ Lumbar support (driver side only)
- ④ Position, cushion angle and height (driver side only)

Seats-Head restraints

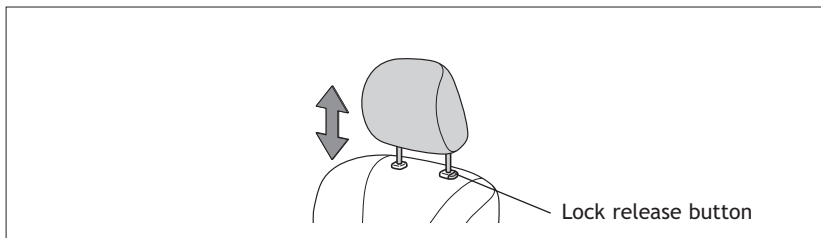

Seats-Folding rear seats

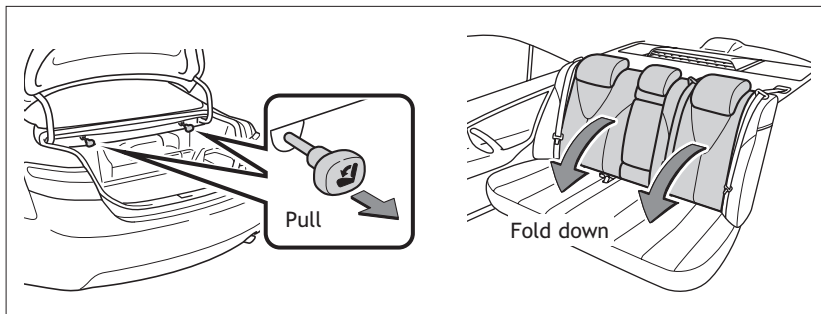

Cruise control

Turning system ON/OFF

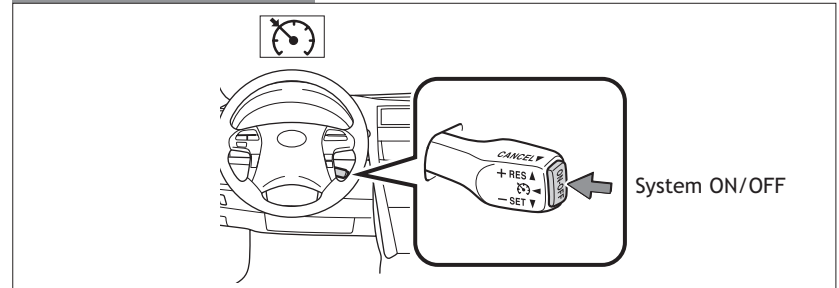

Functions

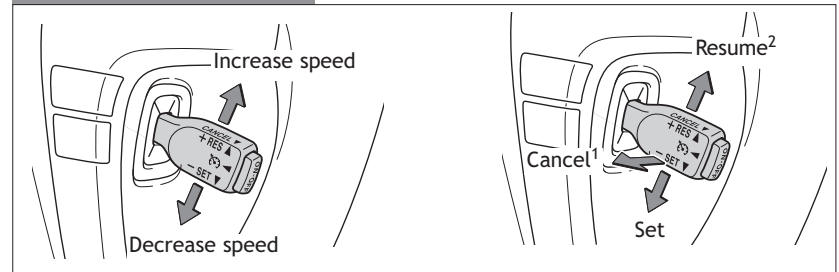

- ¹ The set speed may also be cancelled by depressing the brake pedal.
- ² The set speed may be resumed once vehicle speed exceeds 25 mph.

Garage door opener (HomeLink®)* (if equipped)

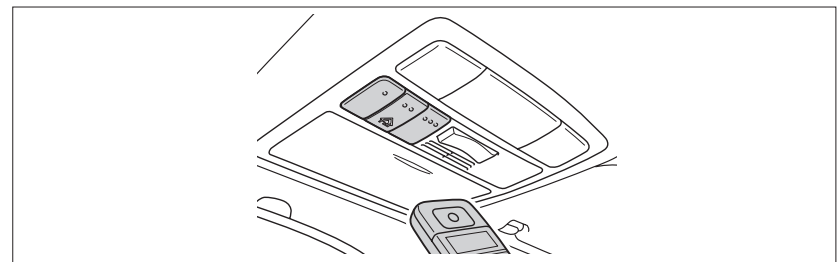

Garage door openers manufactured under license from HomeLink® can be programmed to operate garage doors, estate gates, security lighting, etc.

Refer to “Garage door opener,” Section 3-6 in the *Owner’s Manual* for more details.

For programming assistance, contact the Toyota Customer Experience Center at 1-800-331-4331, or visit <http://www.homelink.com>.

* HomeLink® is a registered trademark of Johnson Controls, Inc.

Telephone controls (Bluetooth® (if equipped))

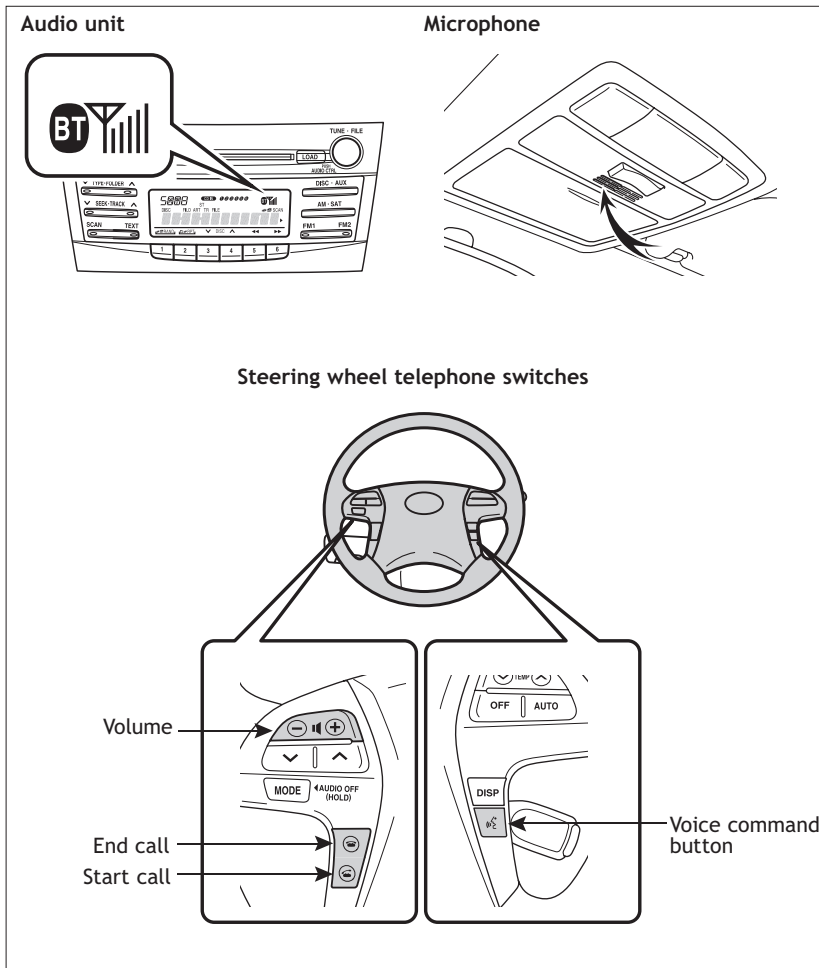

Bluetooth® technology allows you to place or receive calls without taking your hands from the steering wheel or using a cable to connect the compatible telephone and the system.

Refer to “Hands-free phone system (for cellular phone),” Section 3-3 in the *Owner’s Manual* for more details.

Multi-information display

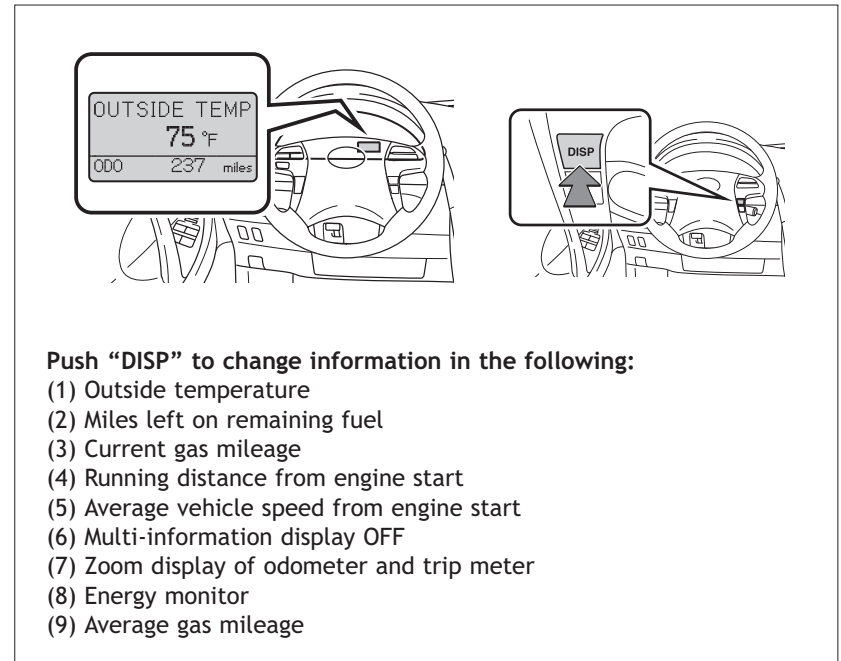

Moonroof (if equipped)

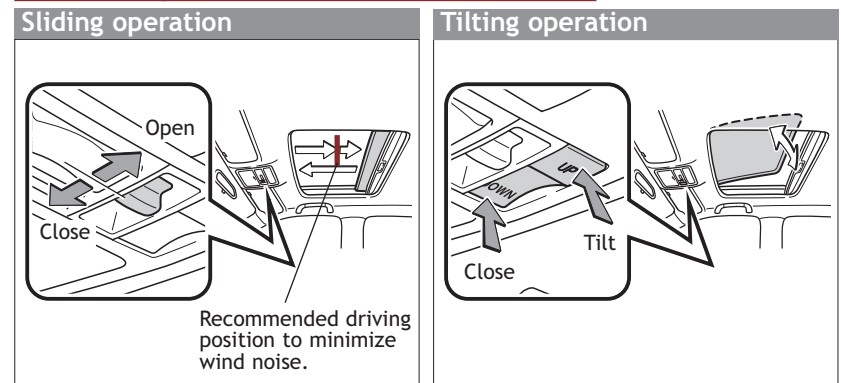

Push once to open; moonroof will automatically stop at the recommended position. Push again to open completely.

Audio

Type 1

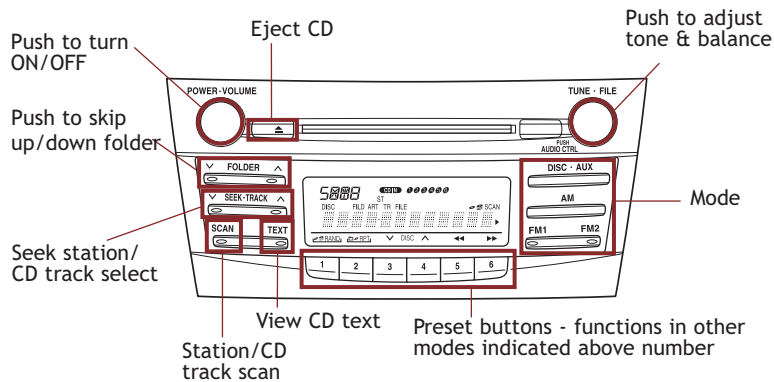

Type 2 other functions

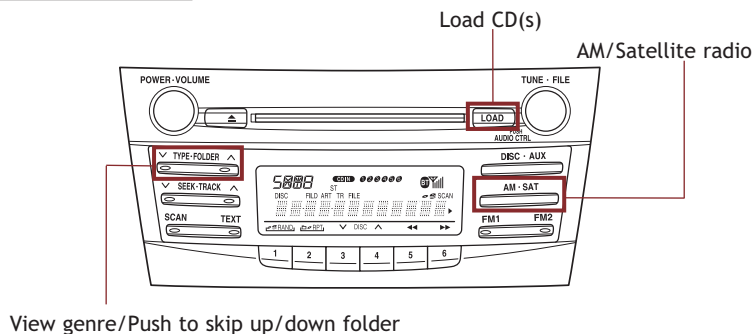

CD PLAYER

To scan tracks on a disc Push and hold “SCAN.” Push again to hold selection.

CD changer (Type 2 only)

-To load one disc Push “LOAD” and insert one disc.

-To load multiple discs Push and hold “LOAD” until you hear a beep. Insert one disc. Shutter will close and then re-open for next disc.

To select a file (MP3/WMA only) Turn “TUNE·FILE.”

To select a folder (MP3/WMA only) Push either side of “FOLDER.”

RADIO

To preset stations Tune in the desired station and hold down a preset button (1-6) until you hear a beep. Push desired preset button (1-6) to select.

To scan stations Push and hold “SCAN” to scan preset stations. Push again to hold selection.

AUX audio jack

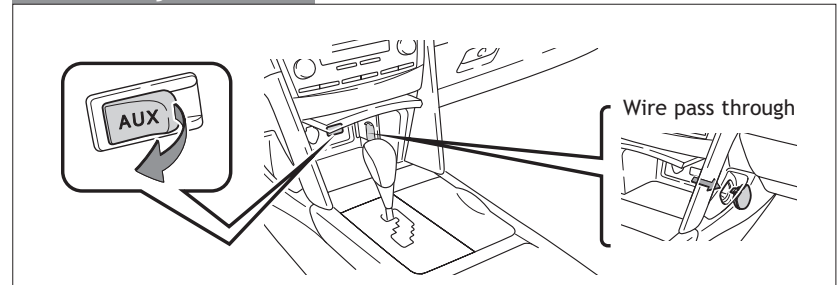

By inserting a mini plug into the AUX audio jack, you can listen to music from a portable audio device through the vehicle’s speaker system.

Steering wheel switches

Audio control

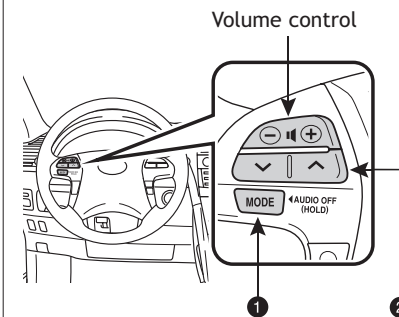

A/C control

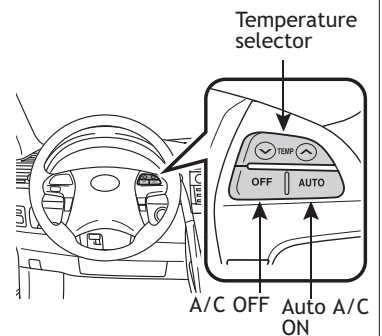

1 “MODE”

Push to turn audio ON and select an audio mode. Push and hold to turn the audio system “OFF.”

2 “V Λ”

-In radio mode Push to select a preset station; push and hold to seek the next strong station.

-In CD mode Push to skip up or down to next/previous track.

Air Conditioning/Heating

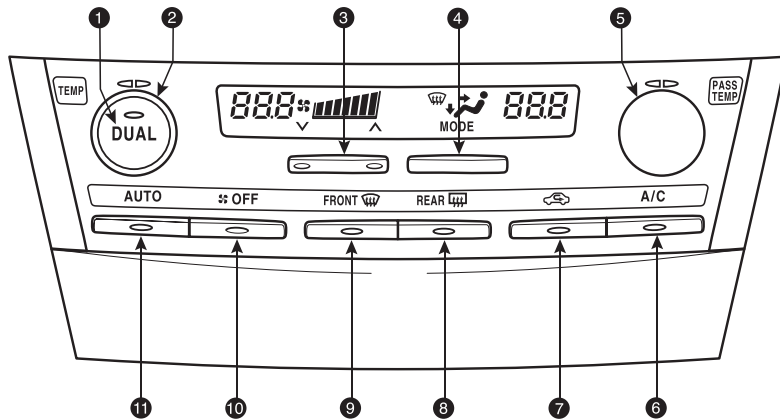

- ❶ “DUAL” button
Indicator ON: Separate temperature settings for driver and passengers.
Indicator OFF: Synchronize temperature settings for driver and passengers.
- ❷ Temperature (driver side)
- ❸ Fan speed
- ❹ Airflow vent
 In “” or “” mode, use fresh air (“” indicator OFF) to reduce window fogging.
- ❺ Temperature (passenger side)
- ❻ Air Conditioning ON/OFF
- ❼ Fresh or recirculated cabin air
- ❽ Rear defogger
- ❾ Windshield airflow/defogger
- ❿ Climate control OFF
- ⓫ Automatic climate control ON
 Adjusting the temperature setting will cause the airflow vents, air intake and fan to adjust automatically.

“ECO HEAT/COOL” switch



NOTE: Slightly improves gas mileage. It may take longer to reach set cabin temperature.

Plasmacluster™*

Improves air quality by emitting positive and negative ions into the cabin. This system operates from the driver side vent and a low system noise is normal.

* This system adopts the plasmacluster technology, manufactured under license from SHARP Corporation. “Plasmacluster™” is a trademark of SHARP Corporation.

Seat heaters (if equipped)

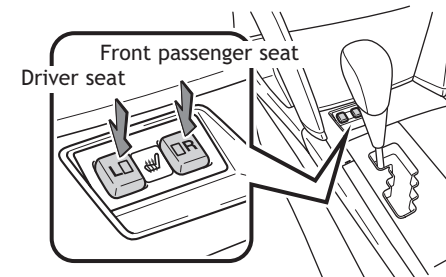

Clock

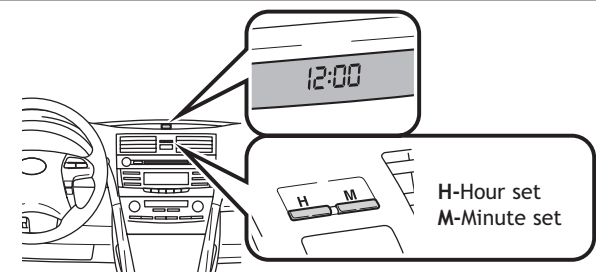

Refer to the *Owner's Manual* for adjusting time.

Door locks

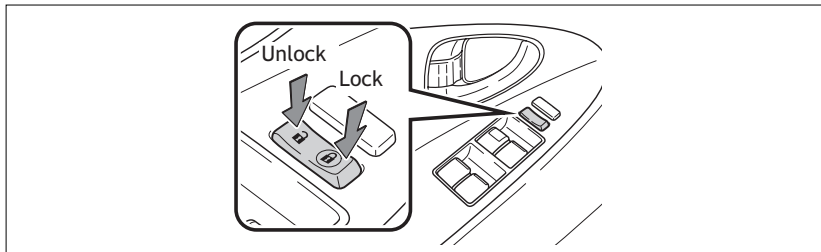

Power outlets

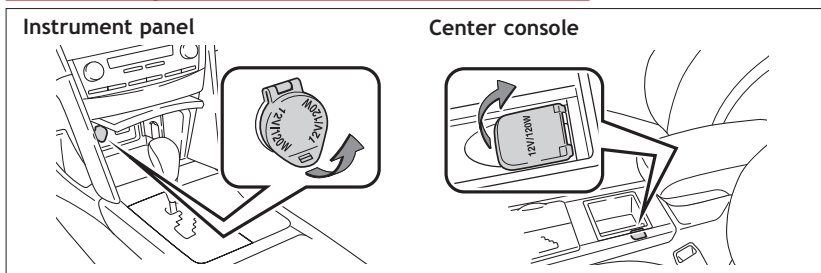

“POWER” switch must be set at “ACC” or “ON” to be used.

Cup holders

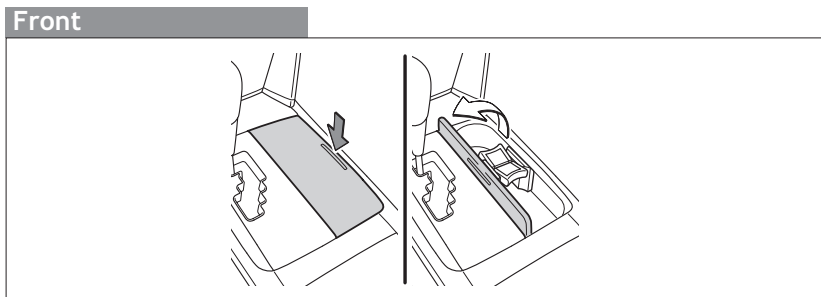

Rear

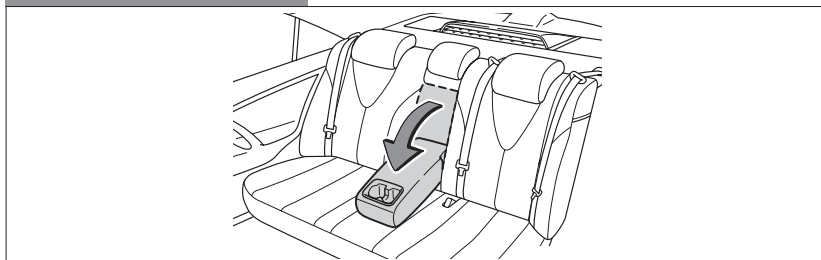

Doors-Child safety locks

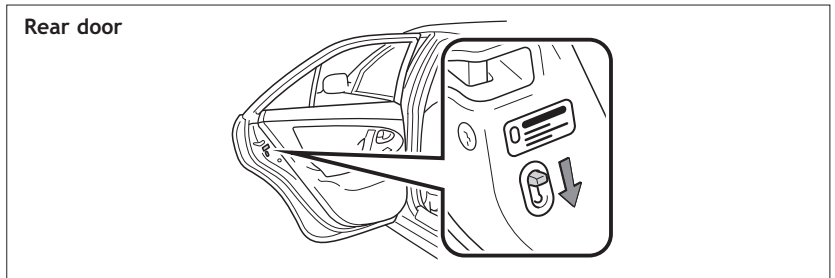

Moving the lever to “LOCK” will allow the door to be opened only from the outside.

Seat belts

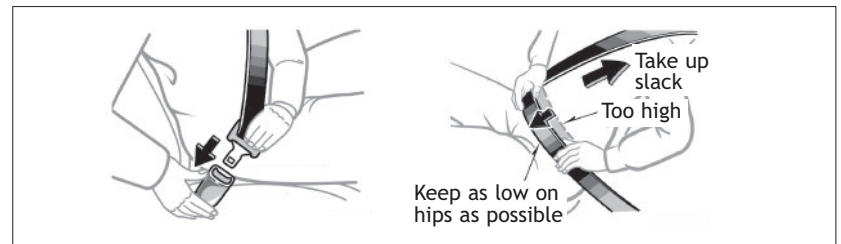

If belt is fully extended, then retracted even slightly, it cannot be re-extended beyond that point, unless fully retracted again. This feature is used to help hold child restraint systems securely.

To find more information about seat belts, and how to install a child restraint system, refer to the *Owner's Manual*.

Fuel filler door-Internal release

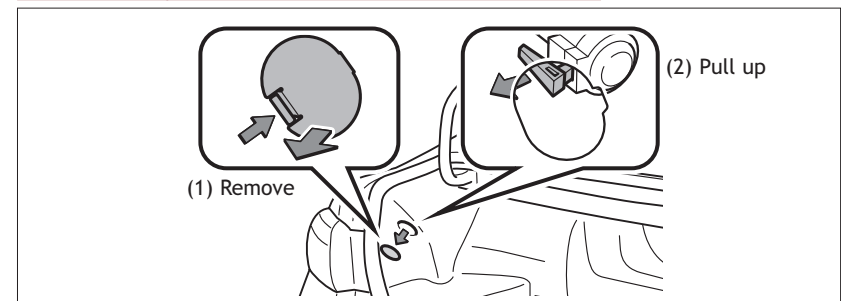

Seat belts-Shoulder belt anchor

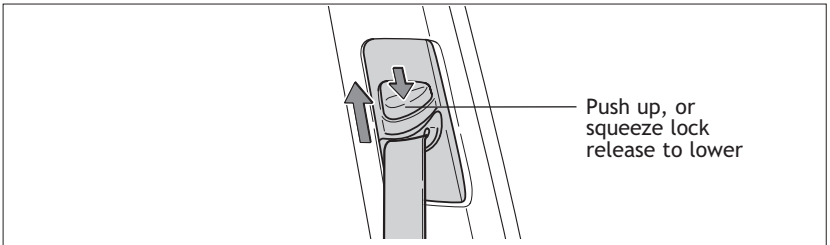

Child comfort guide

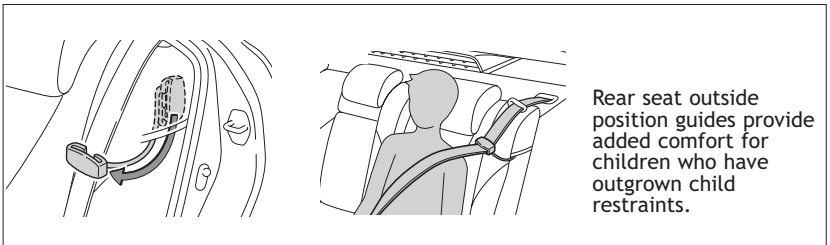

Tire Pressure Warning System

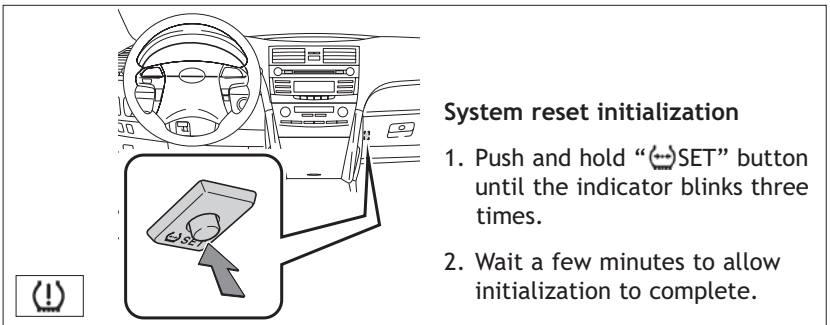

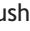
If tire pressure becomes critically low on any of the tires (excluding spare), indicator comes on. Pushing “SET” button should not turn off the light. Correctly adjusting tire inflation will turn off the light after a few minutes. After replacing/rotating tire or wheels, the system must be initialized.

Refer to the *Owner's Manual* for more details.

Trunk-Internal release

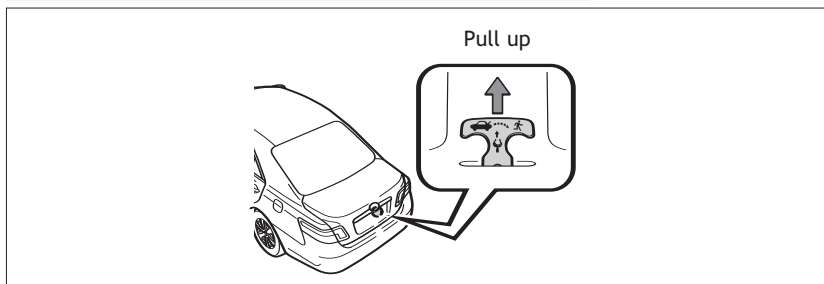

Spare tire & tools

Tool location

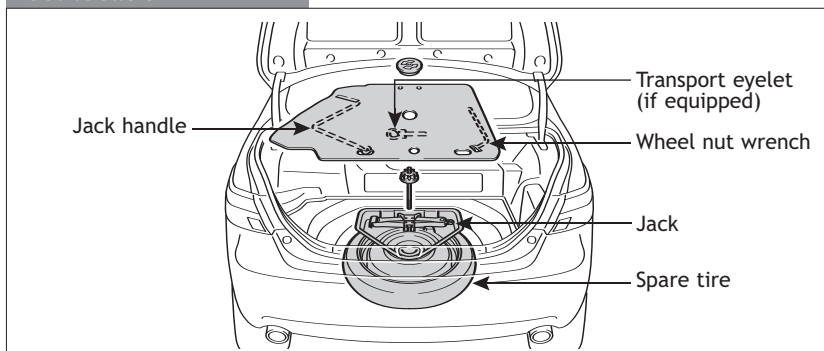

Removing the spare tire

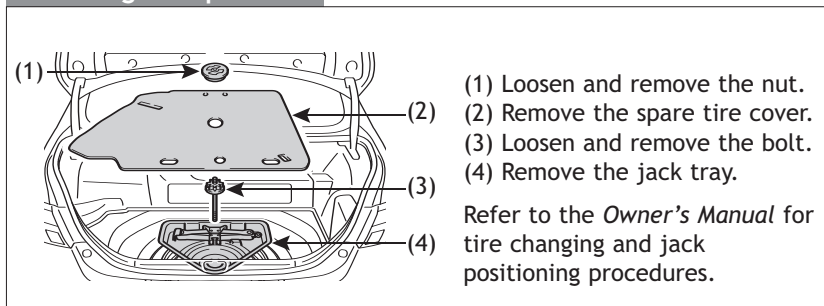



Customer Experience Center
1-800-331-4331